

|   |                 |                    |                      |                         |          |                    |           |                  |   |   |   |   |   |
|---|-----------------|--------------------|----------------------|-------------------------|----------|--------------------|-----------|------------------|---|---|---|---|---|
|   | 13              | 12                 | 11                   | 10                      | 9        | 8                  | 7         | 6                | 5 | 4 | 3 | 2 | 1 |
| J | MATERIAL NUMBER | ENGINEERING NUMBER | MATERIAL NUMBER TAPE | ENGINEERING NUMBER TAPE | WIRE AWG | MWID $\triangle 4$ | ID MIN    | INSULATION COLOR |   |   |   |   |   |
|   | I91640010       | SA-269             | I91640807            | SA-269T                 | 22-18    | .235/5.97          | .054/1.37 | RED              |   |   |   |   |   |
|   | I91640040       | SB-289             | I91640315            | SB-289T                 | 16-14    | .264/6.71          | .080/2.03 | BLUE             |   |   |   |   |   |

(A)

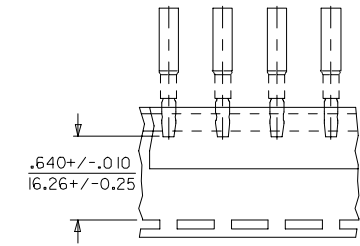

PARTS ON TAPE

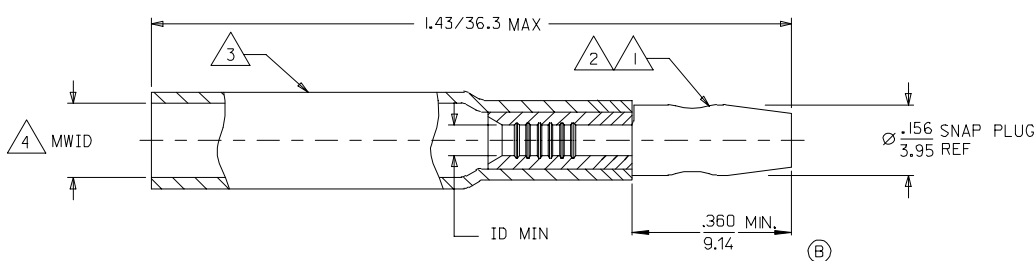

SALES DRAWING

NOTES:

- $\triangle 1$  TERMINAL MATERIAL: COPPER ALLOY
- $\triangle 2$  FINISH: ELECTRO TIN PLATE.
- $\triangle 3$  INSULATION MATERIAL: HEAT SHRINKABLE TUBING WITH HOTMELT ADHESIVE INNER LINER. COLOR: SEE CHART
- $\triangle 4$  MWID = MAXIMUM WIRE INSULATION DIAMETER.

|  |                              |                                       |                      |   |                                   |                        |  |
|--|------------------------------|---------------------------------------|----------------------|---|-----------------------------------|------------------------|--|
| RELEASED<br>FC NO: ETC2007-0054<br>DRWN: JLOMASTRO 2006/08/16<br>CHKD: RDEROSS 2006/08/16<br>APPR: JMACNEIL 2006/08/17<br>REVISION DESCRIPTION | QUALITY SYMBOLS              | GENERAL TOLERANCES (UNLESS SPECIFIED) | DIMENSION STYLE      | SCALE   | DESIGN UNITS                      | THIRD ANGLE PROJECTION |  |
|  | $\nabla = 0$<br>$\nabla = 0$ | mm INCH                               | IN/MM                | ---   | INCH                              |                        |  |
|  |                              | 4 PLACES ± --- ± ---                  | DRAWN BY ASAYDEH     | DATE 05/12/13   | TITLE .156 BULLET PLUG PERMA-SEAL |                        |  |
|  |                              | 3 PLACES ± --- ± ---                  | CHECKED BY JLOMASTRO | DATE 05/12/13   | MOLEX INCORPORATED                |                        |  |
|  | 2 PLACES ± --- ± ---         | APPROVED BY RDEROSS                   | DATE 05/12/13        | DOCUMENT NO. SD-19164-031   |                                   |                        |  |
|  | 1 PLACE ± --- ± ---          | ANGULAR ± --- °                       |                      | SHEET NO. 1 OF 1  |                                   |                        |  |
| DRAFT WHERE APPLICABLE MUST REMAIN WITHIN DIMENSIONS   |                              | SEE CHART                             |                      | THIS DRAWING CONTAINS INFORMATION THAT IS PROPRIETARY TO MOLEX INCORPORATED AND SHOULD NOT BE USED WITHOUT WRITTEN PERMISSION |                                   |                        |  |